



H Style Rod Wiper

A product of MFP Seals.

H STYLE

H STYLE ROD WIPER

MFP Seals' H Style Rod Wipers are a one piece snap-in design, for medium duty cycle applications. MFP Seals' H Style Rod wipers are a standard in industrial cylinders with an AN or BV style U-Cup as rod seals. The H Style Rod Wipers feature a wiper/scrapper lip as well as a secondary U-Cup which serves as an extra safeguard against leakage.

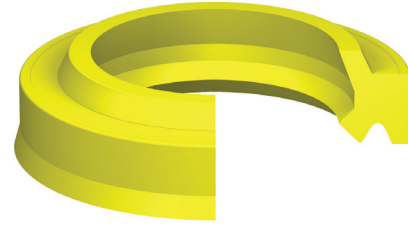

The standard compound for this seal is U2145. It is also available in U2150, U2151, U2162, U4150, H2155, CN80, V7625 and VT90.

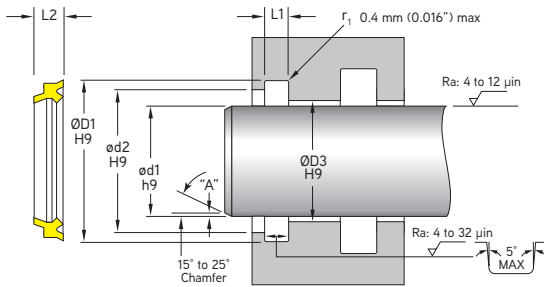

MFP PART NUMBER

H-0250U2145

SEAL TYPE ød1 COMPOUND

Max. Velocity: 0.5 m/s (< 1.6 ft./s)

ROD WIPERS

MFP PART NUMBER	ROD APPLICATION					
	ød1	ØD1	L1	ød2	ØD3	L2
TOLERANCE	h9	H9	+0.005/-0.000	H9	H9	
H-0500	0.500	0.802	0.203	0.620	0.501	0.245
H-0625	0.625	0.927	0.203	0.745	0.626	0.245
H-0750	0.750	1.052	0.203	0.870	0.751	0.245
H-0875	0.875	1.240	0.218	1.010	0.876	0.275
H-1000	1.000	1.365	0.218	1.135	1.001	0.275
H-1125	1.125	1.490	0.218	1.260	1.126	0.275
H-1250	1.250	1.615	0.218	1.385	1.251	0.275
H-1375	1.375	1.740	0.218	1.510	1.376	0.275
H-1500	1.500	1.865	0.218	1.635	1.501	0.275
H-1625	1.625	1.990	0.218	1.760	1.626	0.275
H-1750	1.750	2.115	0.218	1.885	1.751	0.275
H-1875	1.875	2.240	0.218	2.010	1.876	0.275
H-2000	2.000	2.365	0.218	2.135	2.001	0.275
H-2125	2.125	2.490	0.218	2.260	2.126	0.275
H-2250	2.250	2.745	0.281	2.385	2.251	0.351
H-2375	2.375	2.870	0.281	2.510	2.376	0.351
H-2500	2.500	2.995	0.281	2.635	2.501	0.351
H-2625	2.625	3.120	0.281	2.760	2.626	0.351
H-2750	2.750	3.245	0.281	2.885	2.751	0.351
H-3000	3.000	3.495	0.281	3.135	3.001	0.351
H-3250	3.250	3.745	0.281	3.385	3.251	0.351
H-3500	3.500	3.995	0.281	3.635	3.501	0.351
H-3750	3.750	4.245	0.281	3.885	3.751	0.351

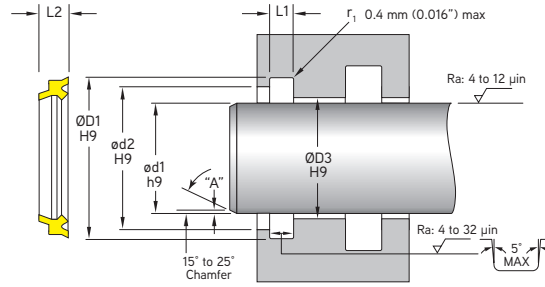

H STYLE

MFP PART NUMBER	ROD APPLICATION					
	Ød1	ØD1	L1	Ød2	ØD3	L2
TOLERANCE	h9	H9	+0.005/-0.000	H9	H9	
H-4000	4.000	4.495	0.281	4.135	4.001	0.351
H-4250	4.250	4.745	0.281	4.385	4.251	0.351
H-4500	4.500	4.995	0.281	4.635	4.501	0.351
H-4750	4.750	5.245	0.281	4.885	4.751	0.351
H-5000	5.000	5.495	0.281	5.135	5.001	0.351
H-5250	5.250	5.745	0.281	5.385	5.251	0.351
H-5500	5.500	5.995	0.281	5.635	5.501	0.351
H-6000	6.000	6.495	0.281	6.135	6.001	0.351
H-6500	6.500	6.995	0.281	6.635	6.501	0.351
H-7000	7.000	7.495	0.281	7.135	7.001	0.351
H-7500	7.500	7.995	0.281	7.635	7.501	0.351
H-8000	8.000	8.495	0.281	8.135	8.001	0.351
H-8500	8.500	8.995	0.281	8.635	8.501	0.351

ROD WIPERS