

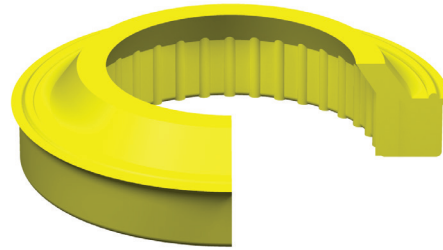

DM STYLE ROD WIPER

MFP Seals' industry standard, DM Style Rod Wipers are designed to fit into a standard housing and provide heavy duty exclusion of dirt and debris. Designed to ensure maximum contact with the wiping surface, the DM Style Rod Wiper includes an outer diameter sealing lip providing a tailored fit within the housing. A sealing bead is also provided to prevent moisture and contaminants from passing the outside of the wiper. The inside diameter of the wiper has ribbing for pressure relief to prevent blow-out.



The standard compound for this seal is U2145.
It is also available in U2150, U2151, U4150 and H2155.

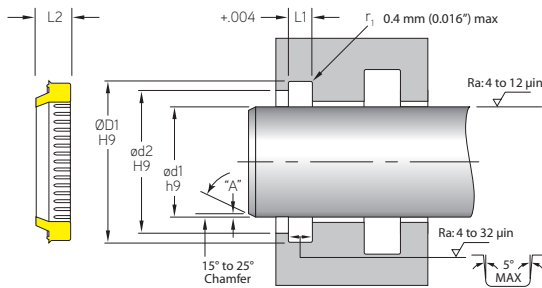

MFP PART NUMBER
DM-0625U2145
SEAL TYPE ød1 COMPOUND

Max. Velocity: 0.5 m/s (< 1.6 ft./s)

MFP PART NUMBER	ROD APPLICATION				
	ød1	ØD1	L1	ød2	L2
TOLERANCE	h9	H9	+0.004/-0.000	+0.005/-0.000	
DM-0625	0.625	0.872	0.124	0.785	0.210
DM-0750	0.750	1.122	0.187	0.995	0.305
DM-0875	0.875	1.247	0.187	1.120	0.305
DM-1000	1.000	1.372	0.187	1.245	0.305
DM-1125	1.125	1.497	0.187	1.370	0.305
DM-1250	1.250	1.622	0.187	1.495	0.305
DM-1375	1.375	1.747	0.187	1.620	0.305
DM-1500	1.500	1.872	0.187	1.745	0.305
DM-1750	1.750	2.122	0.187	1.995	0.305
DM-2000	2.000	2.497	0.249	2.327	0.395
DM-2250	2.250	2.747	0.249	2.577	0.395
DM-2500	2.500	2.997	0.249	2.827	0.395
DM-2750	2.750	3.247	0.249	3.077	0.395
DM-2875	2.875	3.372	0.249	3.202	0.395
DM-3000	3.000	3.497	0.249	3.327	0.395
DM-3375	3.375	3.872	0.249	3.702	0.395
DM-3500	3.500	3.997	0.249	3.827	0.395
DM-4000	4.000	4.497	0.249	4.327	0.395
DM-4500	4.500	5.247	0.374	4.993	0.585
DM-5000	5.000	5.747	0.374	5.493	0.585
DM-5500	5.500	6.247	0.374	5.993	0.585
DM-6000	6.000	6.747	0.374	6.493	0.585