



DF Style Rod Wiper

A product of MFP Seals.

DF STYLE

DF ROD WIPER

MFP Seals' DF rod wiper is an aggressive wiper designed to retro-fit D Style housings. Designed for use in harsh environments, particularly for Longwall Mining, Agriculture, Off-Highway, Waste Management, and Forestry use.

MFP's DF wiper offers a vented heel to eliminate the possibility of pressure traps between the rod seal and wiper. DF wipers feature a protective flange to shield the housing from contaminants. Easy to install and available in several compounds to meet your application's needs.

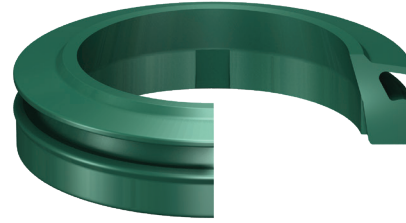

**The standard compound for this seal is U2150.
It is also available in U2151 and U4150.**

For compound descriptions and temperature ranges, please refer to pages 26-37.

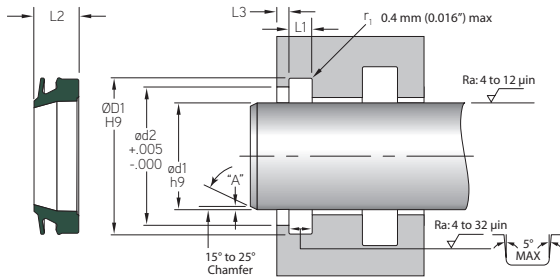

MFP PART NUMBER

DF-1125U2150

SEAL TYPE DASH # COMPOUND

For non-standard groove sizes, see MFP Seals' HMW (Inch) or MHMW (Metric) Rod Wiper.

Max. Velocity: 4.0 m/s (< 12 ft./s)

ROD WIPERS

MFP PART NUMBER	ROD APPLICATION					
	ød1	ØD1	L1	ød2	L2	L3
TOLERANCE	h9	H9	+0.04/-0.000	+0.005/-0.000		
DF-1125	1.125	1.497	0.187	1.370	0.350	0.094
DF-1250	1.250	1.622	0.187	1.495	0.350	0.094
DF-1375	1.375	1.747	0.187	1.620	0.350	0.094
DF-1500	1.500	1.872	0.187	1.745	0.350	0.094
DF-1625	1.625	1.997	0.187	1.870	0.350	0.094
DF-1750	1.750	2.122	0.187	1.995	0.350	0.094
DF-2000	2.000	2.497	0.249	2.327	0.450	0.125
DF-2250	2.250	2.747	0.249	2.577	0.450	0.125
DF-2500	2.500	2.997	0.249	2.827	0.450	0.125
DF-2750	2.750	3.247	0.249	3.077	0.450	0.125
DF-3000	3.000	3.497	0.249	3.327	0.450	0.125
DF-3500	3.500	3.997	0.249	3.827	0.450	0.125
DF-4000	4.000	4.497	0.249	4.327	0.450	0.125
DF-4500	4.500	5.247	0.374	4.993	0.674	0.187
DF-5000	5.000	5.747	0.374	5.493	0.674	0.187
DF-5500	5.500	6.247	0.374	5.993	0.674	0.187
DF-6000	6.000	6.747	0.374	6.493	0.674	0.187
DF-7000	7.000	7.747	0.374	7.493	0.674	0.187