



Block Vee - Symmetrical U-Cup

A product of MFP Seals.

MFPSEALS
www.mfpseals.com

BV

BLOCK VEE - SYMMETRICAL U-CUP

Block Vee Style U-Cups are very popular in industrial cylinders and can be used as piston or rod seals. Back-up rings are available and required for use above 500 PSI. When used with back-up rings, system pressure should not exceed 2,500 PSI. Style 74 or H rod wipers are required when used as a rod seal. Simple design, used when long service life is required.

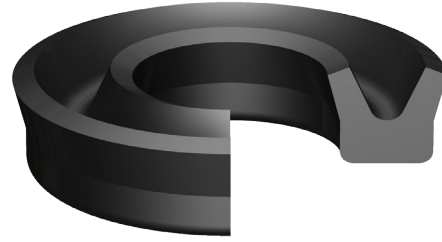

MFP PART NUMBER

BV-0012-3N6015

SEAL TYPE | COMPOUND
INSIDE DIAMETER | C/S OR HT IN 32^{nds}

This seal is available in compounds N6015, N6023 and V7300.

For increased chemical and temperature resistance, other compounds are available (See pages 20-37).

U-CUP SYMMETRICAL

PROFILE

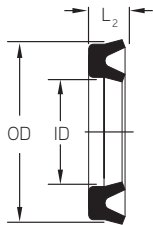

ROD APPLICATION

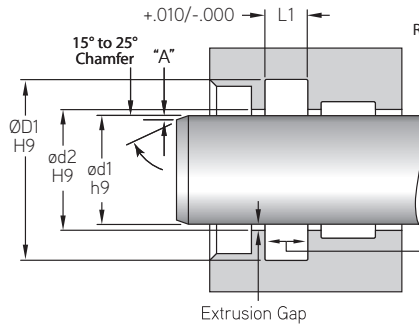

PISTON APPLICATION

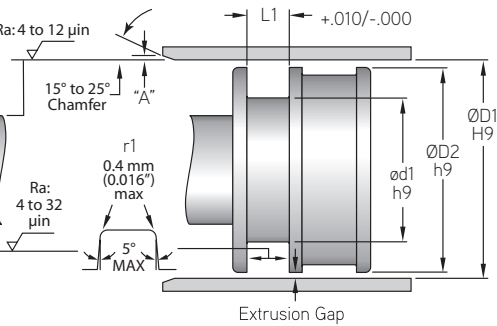

Pressure:

Pneumatic: 17 bar (250 psi) - Hydraulic: 172 bar (2,500 psi)

Max. Velocity:

Pneumatic: 1.0 m/s (3 ft/s) - Hydraulic: 0.5 m/s (1.5 ft/s)

MFP PART NUMBER	PISTON APPLICATION						
	ød1	ød2	ØD1	ØD2	L2	L1	C/S
TOLERANCE	h9	H9	H9	h9		+.010/-0.000	
BV-0012-3	0.125	0.126	0.312	0.311	0.093	0.125	0.093
BV-0018-3	0.187	0.188	0.375	0.374	0.093	0.125	0.093
BV-0018-4	0.187	0.188	0.437	0.436	0.125	0.156	0.125
BV-0025-4	0.250	0.251	0.500	0.499	0.125	0.156	0.125
BV-0031-4	0.312	0.313	0.562	0.561	0.125	0.156	0.125
BV-0037-4	0.375	0.376	0.625	0.624	0.125	0.156	0.125
BV-0043-4	0.437	0.438	0.687	0.686	0.125	0.156	0.125
BV-0050-4	0.500	0.501	0.750	0.749	0.125	0.156	0.125
BV-0056-4	0.562	0.563	0.812	0.811	0.125	0.156	0.125
BV-0062-4	0.625	0.626	0.875	0.874	0.125	0.156	0.125
BV-0068-4	0.687	0.688	0.937	0.936	0.125	0.156	0.125
BV-0075-4	0.750	0.751	1.000	0.999	0.125	0.156	0.125

Compound information available on pages 20-37.

Surface Finish: ISO 4287 & Chamfer Information on pages 7-9. For ISO tolerance charts, refer to pages 12-13.

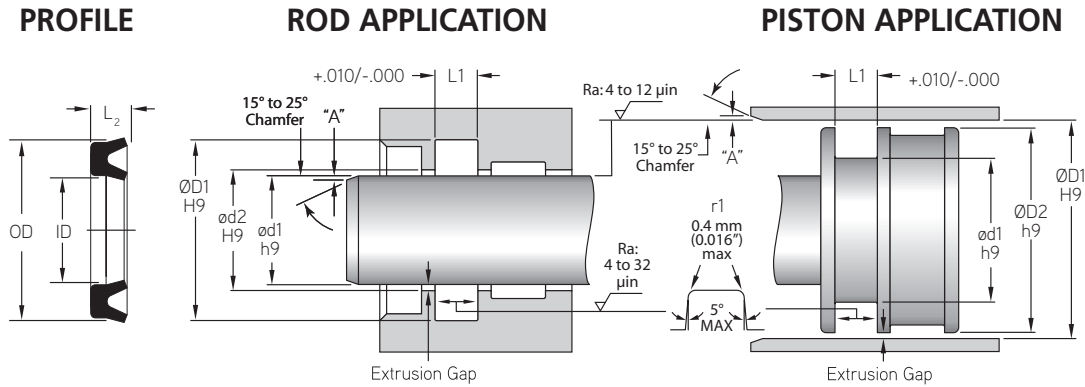

BV

MFP PART NUMBER	PISTON APPLICATION						
	ød1	ød2	ØD1	ØD2	L2	L1	C/S
TOLERANCE	h9	H9	H9	h9		+0.010/-0.000	
BV-0081-4	0.812	0.813	1.062	1.061	0.125	0.156	0.125
BV-0087-4	0.875	0.876	1.125	1.124	0.125	0.156	0.125
BV-0093-4	0.937	0.938	1.187	1.186	0.125	0.156	0.125
BV-0093-5	0.937	0.938	1.250	1.249	0.156	0.187	0.156
BV-0100-4	1.000	1.001	1.250	1.249	0.125	0.156	0.125
BV-0100-5	1.000	1.001	1.312	1.311	0.156	0.187	0.156
BV-0106-5	1.062	1.063	1.375	1.374	0.156	0.187	0.156
BV-0112-5	1.125	1.126	1.437	1.436	0.156	0.187	0.156
BV-0118-5	1.187	1.188	1.500	1.499	0.156	0.187	0.156
BV-0125-5	1.250	1.251	1.562	1.561	0.156	0.187	0.156
BV-0131-5	1.312	1.313	1.625	1.624	0.156	0.187	0.156
BV-0137-5	1.375	1.376	1.687	1.686	0.156	0.187	0.156
BV-0143-5	1.437	1.438	1.750	1.749	0.156	0.187	0.156
BV-0150-6	1.500	1.501	1.875	1.874	0.187	0.218	0.187
BV-0162-6	1.625	1.626	2.000	1.999	0.187	0.218	0.187
BV-0175-6	1.750	1.751	2.125	2.124	0.187	0.218	0.187
BV-0187-6	1.875	1.876	2.250	2.249	0.187	0.218	0.187
BV-0200-6	2.000	2.001	2.375	2.374	0.187	0.218	0.187
BV-0212-6	2.125	2.126	2.500	2.499	0.187	0.218	0.187
BV-0225-6	2.250	2.251	2.625	2.624	0.187	0.218	0.187
BV-0237-6	2.375	2.376	2.750	2.749	0.187	0.218	0.187
BV-0250-6	2.500	2.501	2.875	2.874	0.187	0.218	0.187
BV-0256-7	2.562	2.563	3.000	2.999	0.218	0.250	0.218
BV-0275-7	2.750	2.751	3.187	3.186	0.218	0.250	0.218
BV-0281-7	2.812	2.813	3.250	3.249	0.218	0.250	0.218
BV-0300-7	3.000	3.001	3.437	3.436	0.218	0.250	0.218
BV-0306-7	3.062	3.063	3.500	3.499	0.218	0.250	0.218
BV-0331-7	3.312	3.313	3.750	3.749	0.218	0.250	0.218
BV-0350-8	3.500	3.501	4.000	3.999	0.250	0.281	0.250
BV-0375-8	3.750	3.751	4.250	4.249	0.250	0.281	0.250
BV-0400-8	4.000	4.001	4.500	4.499	0.250	0.281	0.250

U-CUP SYMMETRICAL



Block Vee - Symmetrical U-Cup

A product of MFP Seals.

MFPSEALS

www.mfpseals.com

BV

PROFILE

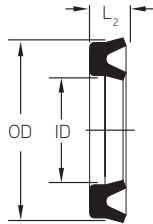

ROD APPLICATION

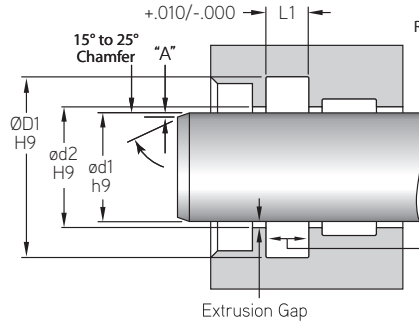

PISTON APPLICATION

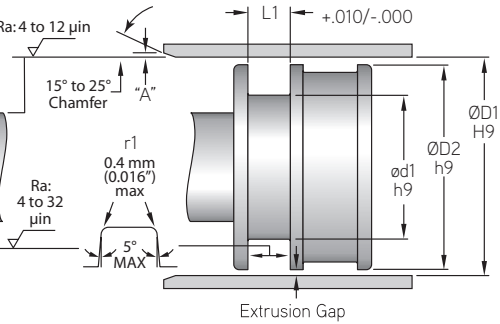

MFP PART NUMBER	PISTON APPLICATION						
	ød1	ød2	ØD1	ØD2	L2	L1	C/S
TOLERANCE	h9	H9	H9	h9		+0.010/-0.000	
BV-0425-8	4.250	4.251	4.750	4.749	0.250	0.281	0.250
BV-0443-9	4.437	4.438	5.000	4.999	0.281	0.312	0.281
BV-0450-8	4.500	4.501	5.000	4.999	0.250	0.281	0.250
BV-0500-9	5.000	5.001	5.562	5.561	0.281	0.312	0.281
BV-0537-10	5.375	5.376	6.000	5.999	0.312	0.344	0.312
BV-0543-9	5.437	5.438	6.000	5.999	0.281	0.312	0.281
BV-0550-10	5.500	5.501	6.125	6.124	0.312	0.344	0.312
BV-0637-10	6.375	6.376	7.000	6.999	0.312	0.344	0.312
BV-0737-10	7.375	7.376	8.000	7.999	0.312	0.344	0.312
BV-0931-11	9.312	9.313	10.000	9.999	0.343	0.375	0.343
BV-1100-16	11.000	11.001	12.000	11.999	0.500	0.550	0.500
BV-1125-12	11.250	11.251	12.000	11.999	0.375	0.406	0.375
BV-1300-16	13.000	13.001	14.000	13.999	0.500	0.550	0.500

U-CUP SYMMETRICAL