

MPWS - C4000 TIGHT TOLERANCE COMPOSITE WEAR STRIP

MFP Seals' proprietary Tight Tolerance C4000 Composite Wear Strip is designed to eliminate scoring in hydraulic and pneumatic applications by preventing metal to metal contact.

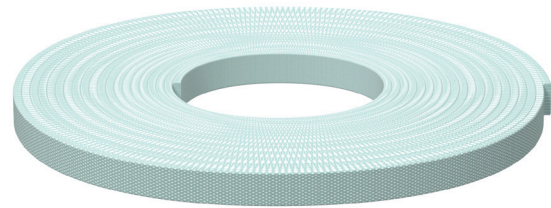

MFP PART NUMBER

MPWS-2.0x05.5C4000-RL

SEAL TYPE C/S L1 COMPOUND ROLL

See page 6 for guide ring cutting instructions.

PROFILE

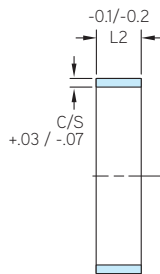

ROD APPLICATION

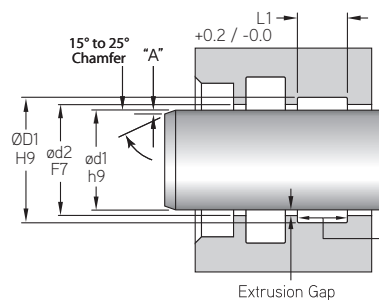

PISTON APPLICATION

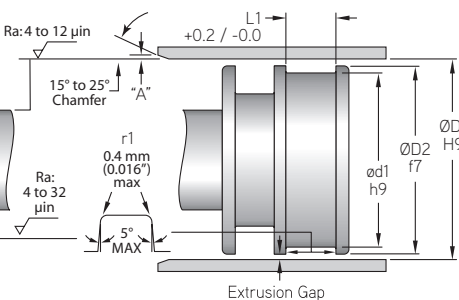

MFP PART NUMBER	ROD OR PISTON APPLICATION			ROLL LENGTH
	C/S	L1	L2	
TOLERANCE	+0.3/-0.7	+0.2/-0.0	-0.1/-0.2	
MPWS-2.0X05.6	2.0	5.6	5.6	10 Meters
MPWS-2.0X09.7	2.0	9.7	9.7	10 Meters
MPWS-2.0X12.0	2.0	12.0	12.0	10 Meters
MPWS-2.0X15.0	2.0	15.0	15.0	10 Meters
MPWS-2.0X20.0	2.0	20.0	20.0	10 Meters
MPWS-2.0X25.0	2.0	25.0	25.0	10 Meters
MPWS-2.0X30.0	2.0	30.0	30.0	10 Meters
MPWS-2.0X35.0	2.0	35.0	35.0	10 Meters
MPWS-2.0X40.0	2.0	40.0	40.0	10 Meters
MPWS-2.0X50.0	2.0	50.0	50.0	10 Meters
MPWS-2.5X05.6	2.5	5.6	5.6	10 Meters
MPWS-2.5X09.7	2.5	9.7	9.7	10 Meters
MPWS-2.5X12.0	2.5	12.0	12.0	10 Meters
MPWS-2.5X15.0	2.5	15.0	15.0	10 Meters
MPWS-2.5X20.0	2.5	20.0	20.0	10 Meters
MPWS-2.5X25.0	2.5	25.0	25.0	10 Meters
MPWS-2.5X30.0	2.5	30.0	30.0	10 Meters
MPWS-2.5X35.0	2.5	35.0	35.0	10 Meters
MPWS-2.5X40.0	2.5	40.0	40.0	10 Meters
MPWS-2.5X50.0	2.5	50.0	50.0	10 Meters
MPWS-3.0X05.6	3.0	5.6	5.6	10 Meters
MPWS-3.0X09.7	3.0	9.7	9.7	10 Meters
MPWS-3.0X12.0	3.0	12.0	12.0	10 Meters

METRIC WEAR STRIP

MPWS - Metric Composite Wear Strip - C4000

A product of MFP Seals.

MFPSEALS
www.mfpseals.com

MPWS C4000

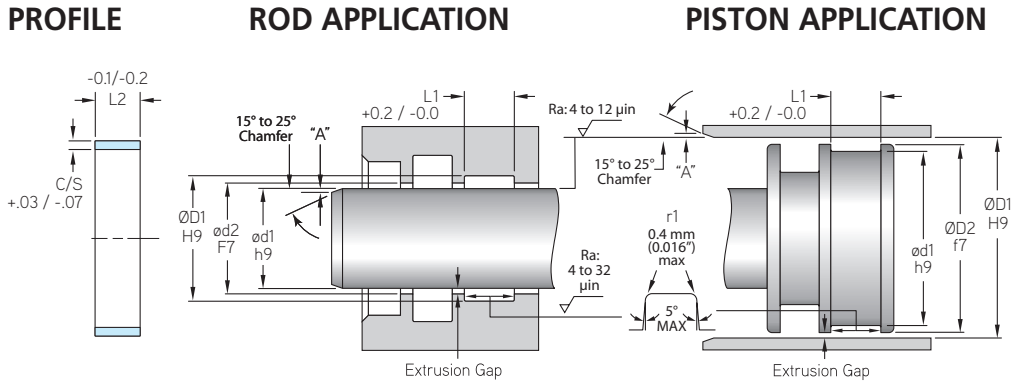

MFP PART NUMBER	ROD OR PISTON APPLICATION			ROLL LENGTH
	C/S	L1	L2	
TOLERANCE	+.03/-0.07	+0.2/-0.0	-0.1/-0.2	
MPWS-3.0X15.0	3.0	15.0	15.0	10 Meters
MPWS-3.0X20.0	3.0	20.0	20.0	10 Meters
MPWS-3.0X25.0	3.0	25.0	25.0	10 Meters
MPWS-3.0X30.0	3.0	30.0	30.0	10 Meters
MPWS-3.0X35.0	3.0	35.0	35.0	10 Meters
MPWS-3.0X40.0	3.0	40.0	40.0	10 Meters
MPWS-3.0X50.0	3.0	50.0	50.0	10 Meters
MPWS-3.5X05.6	3.5	5.6	5.6	10 Meters
MPWS-3.5X09.7	3.5	9.7	9.7	10 Meters
MPWS-3.5X12.0	3.5	12.0	12.0	10 Meters
MPWS-3.5X15.0	3.5	15.0	15.0	10 Meters
MPWS-3.5X20.0	3.5	20.0	20.0	10 Meters
MPWS-3.5X25.0	3.5	25.0	25.0	10 Meters
MPWS-3.5X30.0	3.5	30.0	30.0	10 Meters
MPWS-3.5X35.0	3.5	35.0	35.0	10 Meters
MPWS-3.5X40.0	3.5	40.0	40.0	10 Meters
MPWS-3.5X50.0	3.5	50.0	50.0	10 Meters
MPWS-4.0X05.6	4.0	5.6	5.6	10 Meters
MPWS-4.0X09.7	4.0	9.7	9.7	10 Meters
MPWS-4.0X12.0	4.0	12.0	12.0	10 Meters
MPWS-4.0X15.0	4.0	15.0	15.0	10 Meters
MPWS-4.0X20.0	4.0	20.0	20.0	10 Meters
MPWS-4.0X25.0	4.0	25.0	25.0	10 Meters
MPWS-4.0X30.0	4.0	30.0	30.0	10 Meters
MPWS-4.0X35.0	4.0	35.0	35.0	10 Meters
MPWS-4.0X40.0	4.0	40.0	40.0	10 Meters
MPWS-4.0X50.0	4.0	50.0	50.0	10 Meters
MPWS-5.0X05.6	5.0	5.6	5.6	10 Meters
MPWS-5.0X09.7	5.0	9.7	9.7	10 Meters
MPWS-5.0X12.0	5.0	12.0	12.0	10 Meters
MPWS-5.0X15.0	5.0	15.0	15.0	10 Meters
MPWS-5.0X20.0	5.0	20.0	20.0	10 Meters
MPWS-5.0X25.0	5.0	25.0	25.0	10 Meters
MPWS-5.0X30.0	5.0	30.0	30.0	10 Meters
MPWS-5.0X35.0	5.0	35.0	35.0	10 Meters
MPWS-5.0X40.0	5.0	40.0	40.0	10 Meters
MPWS-5.0X50.0	5.0	50.0	50.0	10 Meters

METRIC WEAR STRIP