

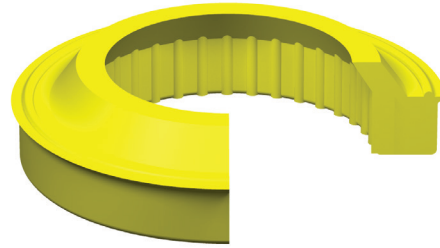

MDRW - METRIC ROD WIPER

MFP Seals' MDRW wipers are for use in light to medium duty hydraulic & pneumatic applications. MFP's MDRW wiper offers a slotted heel to eliminate the possibility of pressure traps between the rod seal and wiper.



The standard compound for this seal is U2145.
It is also available in compounds U2150,
U2151, U4150 and H2155.

MDRW

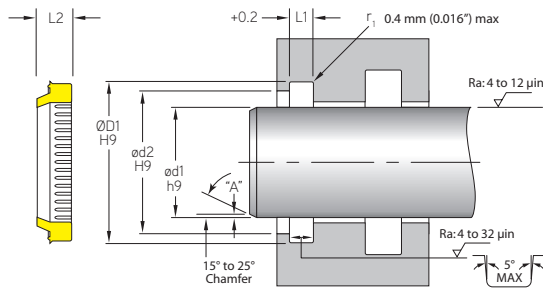

MFP PART NUMBER

MDRW-018x024.6x03.8U2145

SEAL TYPE ød1 ØD1 L1 COMPOUND

Max. Velocity: 0.5 m/s (< 1.6 ft./s)

MFP PART NUMBER	ROD APPLICATION				
	ød1	ød2	ØD1	L1	L2
TOLERANCE	h9	H9	H9	+0.2 / -0	
MDRW-018X024.6X03.8	18	21	24.6	3.8	5.3
MDRW-025X033.6X05.3	25	28	33.6	5.3	7
MDRW-030X038.6X05.3	30	33	38.6	5.3	7
MDRW-035X043.6X05.3	35	38	43.6	5.3	7
MDRW-040X048.6X05.3	40	43	48.6	5.3	7
MDRW-045X053.6X05.3	45	48	53.6	5.3	7
MDRW-045X055.6X05.3	45	48	55.6	5.3	7
MDRW-050X058.6X05.3	50	53	58.6	5.3	7
MDRW-055X063.6X05.3	55	58	63.6	5.3	7
MDRW-060X068.6X05.3	60	63	68.6	5.3	7
MDRW-063X073.6X05.3	63	66	73.6	5.3	7
MDRW-070X078.6X05.3	70	73	78.6	5.3	7
MDRW-070X080.6X05.3	70	73	80.6	5.3	7
MDRW-075X083.6X05.3	75	78	83.6	5.3	7
MDRW-080X088.6X05.3	80	83	88.6	5.3	7
MDRW-080X092.2X07.1	80	86	92.2	7.1	12
MDRW-085X093.6X05.3	85	88	93.6	5.3	7
MDRW-090X102.2X07.1	90	96	102.2	7.1	12
MDRW-095X107.2X07.1	95	101	107.2	7.1	12
MDRW-100X112.2X07.1	100	106	112.2	7.1	12

METRIC ROD WIPERS



MDRW - Metric Rod Wiper

A product of MFP Seals.

MFPSEALS[®]

www.mfpseals.com

MDRW

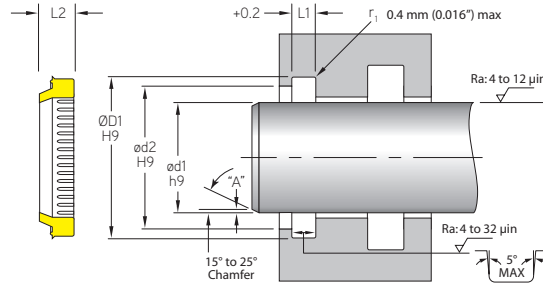

MFP PART NUMBER	ROD APPLICATION				
	ød1	ød2	ØD1	L1	L2
TOLERANCE	h9	H9	H9	+0.2 / -0	
MDRW-110X122.2X07.1	110	116	122.2	7.1	12
MDRW-115X127.2X07.1	115	121	127.2	7.1	12
MDRW-120X132.2X07.1	120	126	132.2	7.1	12
MDRW-125X137.2X07.1	125	131	137.2	7.1	12
MDRW-130X142.2X07.1	130	136	142.2	7.1	12
MDRW-135X147.2X07.1	135	141	147.2	7.1	12
MDRW-140X152.2X07.1	140	145.6	152.2	7.1	12
MDRW-145X157.2X07.1	145	151	157.2	7.1	12
MDRW-150X162.2X07.1	150	156	162.2	7.1	12

METRIC ROD WIPERS