

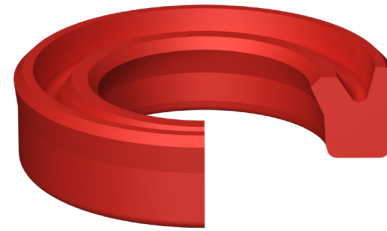

MRU METRIC ASYMMETRICAL ROD SEAL U-CUP

MFP Seals' MRU Metric Rod Seal U-Cup is an asymmetrical design cup seal for use in hydraulic applications. The knife-trimmed primary lip provides superior sealing ability. The design was enhanced using finite element analysis giving you the best product on the market.



The standard compound for this seal is U2151.
It is also available in compounds U2150, U2162, U4150, and H2155.

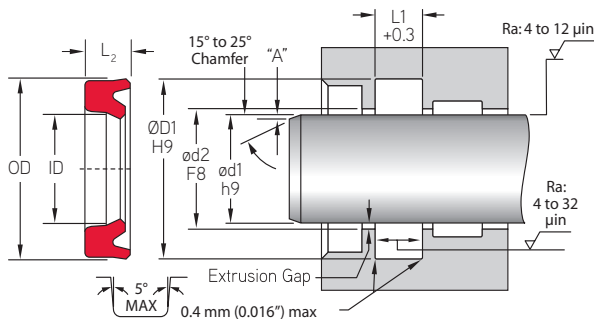

MFP PART NUMBER

MRU-018x026x05U2151

SEAL TYPE ød1 ød2 ØD1 COMPOUND

Larger sizes, not listed, are available but may require tooling.

Pressure: 400 bar (5,800 psi)

Max. Velocity: 0.5 m/s (< 1.6 ft./s)

MFP PART NUMBER	ROD OR PISTON APPLICATION					
	ød1	ød2	ØD1	L2	L1	L1 with B/U
TOLERANCE	h9	F8	H9		+0.3/-0.000	+0.3/-0.000
MRU-018x026x05	18	18	26	5	5.7	7.7
MRU-020x028x05	20	20	28	5	5.7	7.7
MRU-022x030x05	22	22	30	5	5.7	7.7
MRU-022.4x030x05	22.4	22.4	30	5	5.7	7.7
MRU-022.4x030.4x05	22.4	22.4	30.4	5	5.7	7.7
MRU-023.5x031.5x05	23.5	23.5	31.5	5	5.7	7.7
MRU-024x032x05	24	24	32	5	5.7	7.7
MRU-025x031x05	25	25	31	5	5.7	7.7
MRU-025x033x05	25	25	33	5	5.7	7.7
MRU-025x035x05	25	25	35	5	5.7	7.7
MRU-028x035.5x05	28	28	35.5	5	5.7	7.7
MRU-028x036x05	28	28	36	5	5.7	7.7
MRU-030x040x06	30	30	40	6	7	10
MRU-031.5x041.5x06	31.5	31.5	41.5	6	7	10
MRU-035x045x06	35	35	45	6	7	10
MRU-035.5x045x06	35.5	35.5	45	6	7	10
MRU-035.5x045.5x06	35.5	35.5	45.5	6	7	10
MRU-040x048x06.3	40	40	48	6.3	7.3	10.3
MRU-040x050x06	40	40	50	6	7	10
MRU-042x052x07.3	42	42	52	7.3	8.3	11.3
MRU-045x055x06	45	45	55	6	7	10
MRU-045x055x07.3	45	45	55	7.3	8.3	11.3
MRU-045x056x07	45	45	56	7	8	11
MRU-050x060x06	50	50	60	6	7	10
MRU-053x063x06	53	53	63	6	7	10
MRU-055x065x06	55	55	65	6	7	10
MRU-055x068x10	55	55	68	10	11	14
MRU-056x066x06	56	56	66	6	7	10



MRU - Metric Asymmetrical Rod Seal U-Cup

A product of MFP Seals.

MFPSEALS
www.mfpseals.com

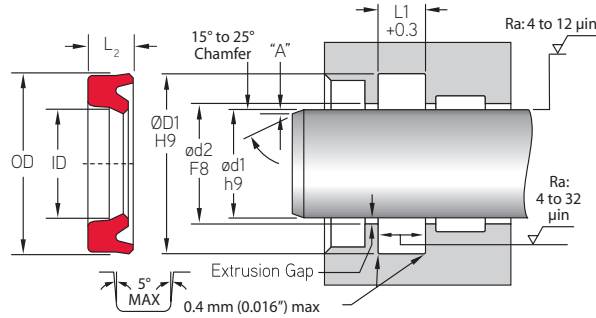

ROD OR PISTON APPLICATION

MFP PART NUMBER	ød1	ød2	ØD1	L2	L1	L1 with B/U
TOLERANCE	h9	F8	H9	f8	+0.3/-0.000	+0.3/-0.000
MRU-056X066X07.3	56	56	66	7.3	8.3	11.3
MRU-060X070X06	60	60	70	6	7	10
MRU-060X071X07	60	60	71	7	8	11
MRU-063X073X06	63	63	73	6	7	10
MRU-063X079X11.5	63	63	79	11.5	12.5	15.5
MRU-065X075X06	65	65	75	6	7	10
MRU-067X077X06	67	67	77	6	7	10
MRU-070X080X06	70	70	80	6	7	10
MRU-071X081X06	71	71	81	6	7	10
MRU-075X085X06	75	75	85	6	7	10
MRU-080X090X06	80	80	90	6	7	10
MRU-085X100X09	85	85	100	9	10	13
MRU-090X105X09	90	90	105	9	10	13
MRU-095X110X09	95	95	110	9	10	13
MRU-098X112X08.5	98	98	112	8.5	9.5	12.5
MRU-100X115X09	100	100	115	9	10	13
MRU-105X120X09	105	105	120	9	10	13
MRU-106X120X08.5	106	106	120	8.5	9.5	12.5
MRU-106X121X09	106	106	121	9	10	13
MRU-110X125X09	110	110	125	9	10	13
MRU-112X125X09	112	112	125	9	10	13
MRU-115X130X09	115	115	130	9	10	13
MRU-118X133X09	118	118	133	9	10	13
MRU-120X135X09	120	120	135	9	10	13
MRU-125X140X09	125	125	140	9	10	13
MRU-130X145X09	130	130	145	9	10	13
MRU-136X150X08.5	136	136	150	8.5	9.5	12.5
MRU-140X155X09	140	140	155	9	10	13
MRU-145X160X09	145	145	160	9	10	13
MRU-150X165X09	150	150	165	9	10	13
MRU-155X170X09	155	155	170	9	10	14
MRU-160X175X09	160	160	175	9	10	14
MRU-165X180X09	165	165	180	9	10	14
MRU-170X185X09	170	170	185	9	10	14
MRU-175X190X09	175	175	190	9	10	14
MRU-180X200x12	180	180	200	12	13	17
MRU-190X210x12	190	190	210	12	13	17
MRU-200X220x12	200	200	220	12	13	17

METRIC U-CUP - ASYMMETRICAL ROD SEAL

MRU